

PROKIT EP 110

The safety system for temporary edge protection

Product Brochure – Issue 09/2016



Content

System advantages

- 5 The safety system for temporary edge protection
- 6 Technically sound: Reliable securing of edges on building shells and formwork
- 8 Quickly assembled: Very few different lightweight system components and self-securing posts
- 10 Flexibly mounted: Numerous possibilities for a wide range of mounting situations

Components

- 12 PROKIT EP 110 system components

Issue 09/2016

Publisher

PERI GmbH
Formwork Scaffolding Engineering
Rudolf-Diesel-Strasse 19
89264 Weissenhorn
Germany
Phone +49 (0)7309.950-0
Fax +49 (0)7309.951-0
info@peri.com
www.peri.com

Important information

All current safety regulations and guidelines applicable in those countries where our products are used must be observed.

The images shown in this brochure feature construction sites in progress. For this reason, safety and anchor details in particular cannot always be considered as conclusive or final. These are subject to the risk assessment carried out by the contractor.

In addition, computer graphics are used which are to be understood as system representations. For ensuring a better understanding, these and the detailed illustrations shown have been partially re-

duced to show certain aspects. The safety installations which have possibly not been shown in these detailed descriptions must nevertheless still be available. The systems or items shown might not be available in every country.

Safety instructions and load specifications are to be strictly observed at all times. Separate structural calculations are required for any deviations from the standard design data.

The information contained herein is subject to technical changes in the interests of progress. Errors and typographical mistakes reserved.







PROKIT EP 110

The safety system for temporary edge protection

The 1.10 m high, quick to assemble PROKIT EP 110 edge protection system provides cost-effective anti-fall protection for open slab edges and numerous other leading edges.

Core components are the galvanized posts, powder-coated Side Mesh Barriers as well as the range of components for fixing the posts. With PROKIT EP 110, flexible edge protection solutions are feasible for many situations without requiring any planning effort – also for complicated structural geometries.

PROKIT EP 110 is particularly quick to assemble: the PROKIT Posts are inserted into the slab or side feet; the 260 cm long Side Mesh Barriers are then easily and simply fixed in position.

The system can be used for numerous other edge securing measures. Posts and Side Mesh Barriers are mounted using a range of clamps, e.g. also on sheet pilings. Furthermore, other accessories also allow the use on different PERI formwork and scaffolding systems; among other things, on the working platforms of the MAXIMO MXK Bracket System.

The versatility and long service life of the robust system components make the PROKIT EP 110 particularly economical. Last but not least, the increased level of safety for the users ensures accelerated working operations and a reduced risk of accidents.



Technically sound

Reliable securing of open building edges on building shells (in accordance with DIN EN 13374 Class A) and on formwork (in accordance with DIN EN 12811)



Quickly assembled

With a minimum of different, lightweight system components and self-securing posts



Flexibly mounted

Variable mounting possibilities to the building shell and PERI formwork systems

Technically sound

Reliable securing of edges on building shells and formwork

PROKIT EP 110 reliably fulfills the requirements regarding regulations involving anti-fall protection on building shells as well as the formwork.

PROKIT EP 110 provides protection against falling in accordance with Class A of DIN 13374 – e.g. at open building edges up to a 10 % angle of inclination of the work surface. The 1.10 m high Side Mesh Barrier with integrated toe board corresponds to the requirements of the standard which calls for a guardrail at least 1.00 m above the working area, an intermediate guardrail as well as a toe board at least 150 mm high. In addition, the Side Mesh Barriers are also compatible with many PERI formwork and scaffolding systems.

The holding brackets on the posts have nail and screw holes already in place so that handrail boards can also be quickly and securely fixed as an alternative to the closed mesh barriers. As a result, staircases, for example, can be easily secured.



With the PERI Uni-Clamp and PERI Guardrail Post, the PROKIT Side Mesh Barrier can be used without drilling into the slab edge.



The holding brackets on the posts have nail and screw holes already in place so that handrail boards can be quickly fixed.



Stairwell areas can be secured with handrail boards which are easy to attach to the posts.



PROKIT EP 110 provides protection on the open edges of the working platforms of this tunnel formwork.



With the help of the post extension and a second mesh barrier, the edge protection can be increased to a height of 1.75 m.



The Side Mesh Barrier is available in lengths of 0.90 m, 1.20 m and 2.40 m. The barrier is used on the MXK Bracket System for the MAXIMO Panel Formwork system as well as TRIO.

Quickly assembled

Very few different lightweight system components and self-securing posts



Installing the PROKIT EP 110 anti-fall protection is uncomplicated, very quick and safe.

The post is automatically secured when inserted into the feet after which the mesh barrier is simply fixed in position. The standard side mesh barrier is 2.60 m long and weighs less than 20 kg which ensures easy and fatigue-free handling.

The large post spacing of up to 2.40 m reduces material requirements as well as assembly time. A shorter barrier serves as compensation so that only small overlaps are necessary.

PROKIT Post PP

The galvanized PROKIT Posts only weigh 4.3 kg. Thanks to a simple, mechanical solution, they are immediately secured without requiring any other measures when inserted into the feet. The side mesh barriers are hung over the two top brackets and subsequently fixed on the integrated toe board by means of the bottom, movable bracket.

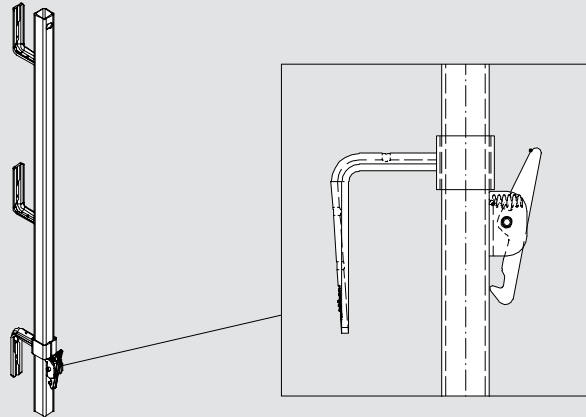

Side Mesh Barrier PMB

The 260 cm long close-meshed side mesh barriers weigh less than 20 kg; shorter barriers are available for compensations. The yellow or red powder coating offers excellent corrosion protection; in addition, it has a strong signal effect for hazardous areas.

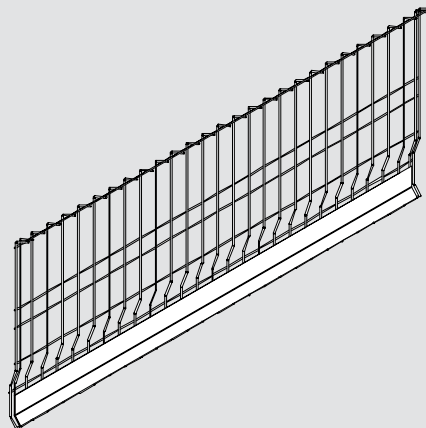

Side Mesh Barrier PMB 260
powder-coated, yellow

On customer request, the Side Mesh Barriers can also be powder-coated in other common RAL colours. In this way, the PROKIT anti-fall protection can also be used for advertising purposes.



Flexibly mounted

Numerous possibilities for a wide range of mounting situations

For the self-securing posts, there is a range of mounting options. Depending on the requirement, there is a range of accessories available, e.g. for mounting on the slab, its front side or parapets.

PROKIT system components are extremely versatile, re-usable many times and allow the highest rates of utilization. In addition, the small number of system components simplifies the entire on-site material requirements and logistics.



PROKIT Post PP

Standard supports for the PROKIT post are the slab foot and side foot. In addition, clamps are available that are simply clamped on the concrete component or the sheet piling.



PROKIT Slab Foot PDF
Mounting on the slab

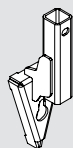

PROKIT Side Foot PSF
Assembly on the front side of the slab, on the wall or flight of stairs

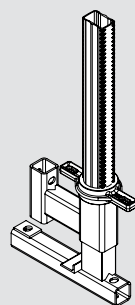

Uni-Clamp PUC
For mounting to the front side of the slab or on a parapet

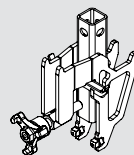

Sheet Piling Clamp
For assembly on sheet piling



If screw-in sleeves have been inserted into the fresh concrete, the slab foot can be mounted using standard Bolts M16-8.8 without requiring any drilling. This is a particular advantage, e.g. for concrete core activation.



The Sheet Piling Clamp PSC allows quick and easy attachment of the Side Mesh Barriers to the sheet piling.

Logistics and transport

A suitable pallet for storage and transport purposes is extremely practical: a total of 25 mesh barriers can be quickly stored in the Pallet EP 110 with space-saving ease – in the exact position in which they are then assembled on the slab edge. The dimensions have been optimized for transportation by truck, have the base area of a Euro pallet and are also stackable. The pallet thus ensures minimized storage space and optimized transport volume, as well as preventing any damage being caused to the Side Mesh Barriers.



Item no.	Weight kg	
117326	19.700	Side-Mesh-Barrier PMB
126376	9.260	Side-Mesh-Barrier PMB 260
		Side Mesh Barrier PMB 120

L
2600
1180

Technical Data

Maximum distance with side-mesh-barrier: PMB 260 max. 2.40 m.

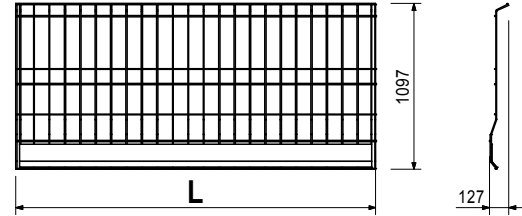
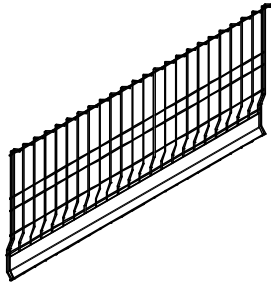

117325	4.270	Post PP For the fixation of the Side-Mesh-Barrier.
--------	-------	--

Technical Data

Maximum distance of posts with Side-Mesh-Barrier: PMB 260 max. 2.40 m.

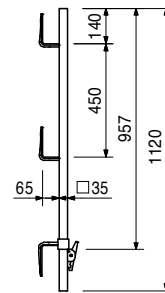

117323	1.530	Slab Foot PDF For assembly of a guardrail on or at edge slabs.
--------	-------	--

Technical Data

Maximum distance of posts with Side-Mesh-Barrier: PMB 260 max. 2.40 m.

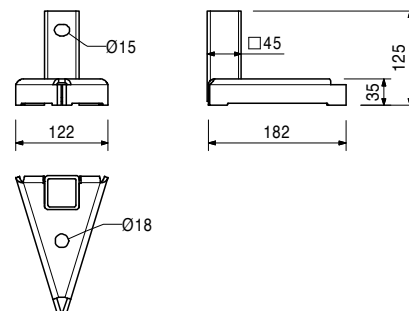
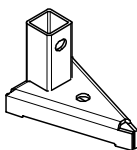

		Accessories
117020	0.213	Anchor Bolt PERI 14 x 150
117325	4.270	Post PP

Item no.	Weight kg
117324	2.210

Side Foot PSF

For assembly of a guardrail on or at walls and stairs.

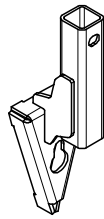

Technical Data

Maximum distance of posts with Side-Mesh-Barrier: PMB 260 max. 2.40 m.

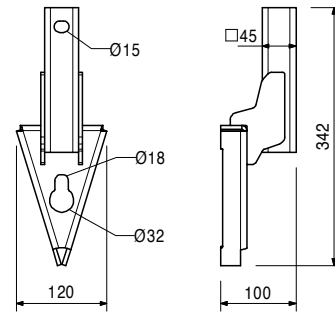

Accessories

117020	0.213
117325	4.270

Anchor Bolt PERI 14 x 150
Post PP

118660	6.610
--------	-------

Uni-Clamp PUC

For the assembly of a guardrail on the front side of slabs or on railings.

Technical Data

Maximum distance of posts with Side-Mesh-Barrier: PMB 260 max. 2.40 m.

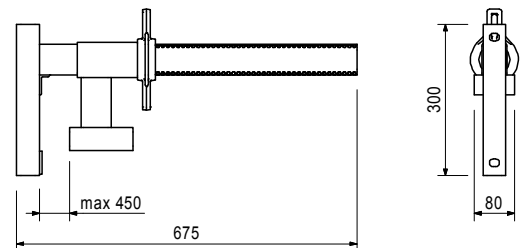
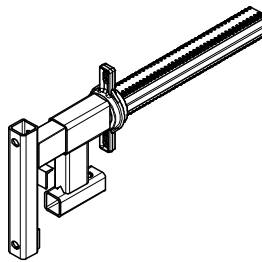

Accessories

117325	4.270
--------	-------

Post PP

126330	4.600
--------	-------

Sheet Piling Clamp PSC

For assembly of a guardrail on sheet piling.

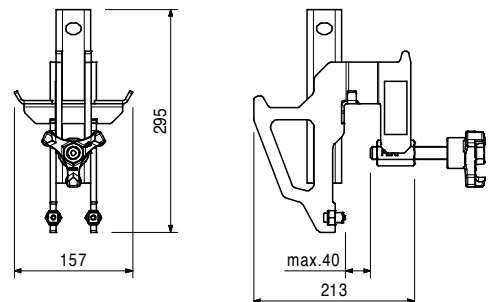
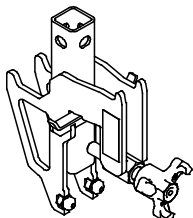

Accessories

117325	4.270
--------	-------

Post PP

Item no.	Weight kg
118296	2.910

Post Increase PPE

For increasing the guardrail to 1.75 m.

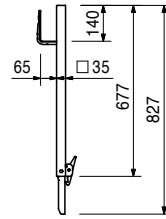

118670	5.030
--------	-------

Front Guardrail Holder ADJ PFH

For mounting safety barriers to slab edges and stairs.

Note

Position of side protection adjustable.

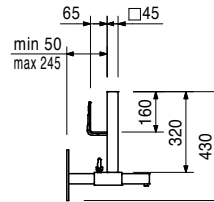
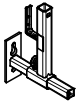

Accessories

117020	0.213
117325	4.270

Anchor Bolt PERI 14 x 150
Post PP

117020	0.213
--------	-------

Anchor Bolt PERI 14 x 150

Re-usable.
Approval available.

Note

Separate Design Information on request.

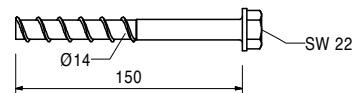
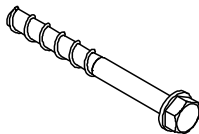

123970	0.047
--------	-------

Screw-On Sleeve PERI M16/164

For temporary mounting of components on reinforced concrete slabs.

Note

Inserted into the fresh concrete immediately after concreting.

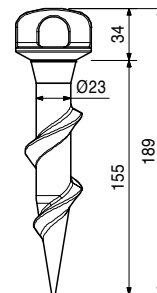
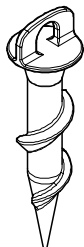

Accessories

123973	0.240
--------	-------

Bolt ISO 4014 M16 x 130-8.8, galv.

Item no.	Weight kg
123973	0.240

Bolt ISO 4014 M16 x 130-8.8, galv.

For assembly of Slab Foots PDF in combination with Screw-On Sleeve PERI M16/164.

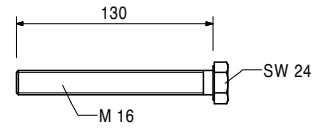
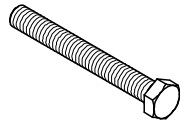

123960	70.400
--------	--------

Pallet EP 110

For stacking and transportation of 25 Side-Mesh-Barrieres PMB.

Complete with

1 pc. 117560 Lashing 25 x 2550 mm

Note

Follow Instructions for Use!

Technical Data

Permissible load-bearing capacity 600 kg.

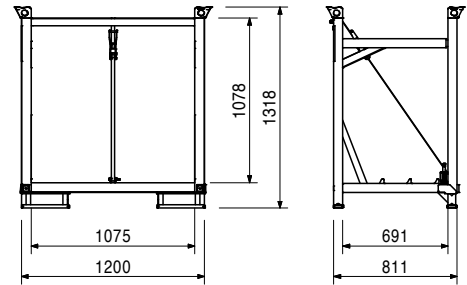
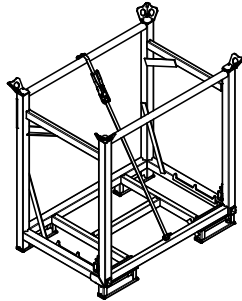

PERI International

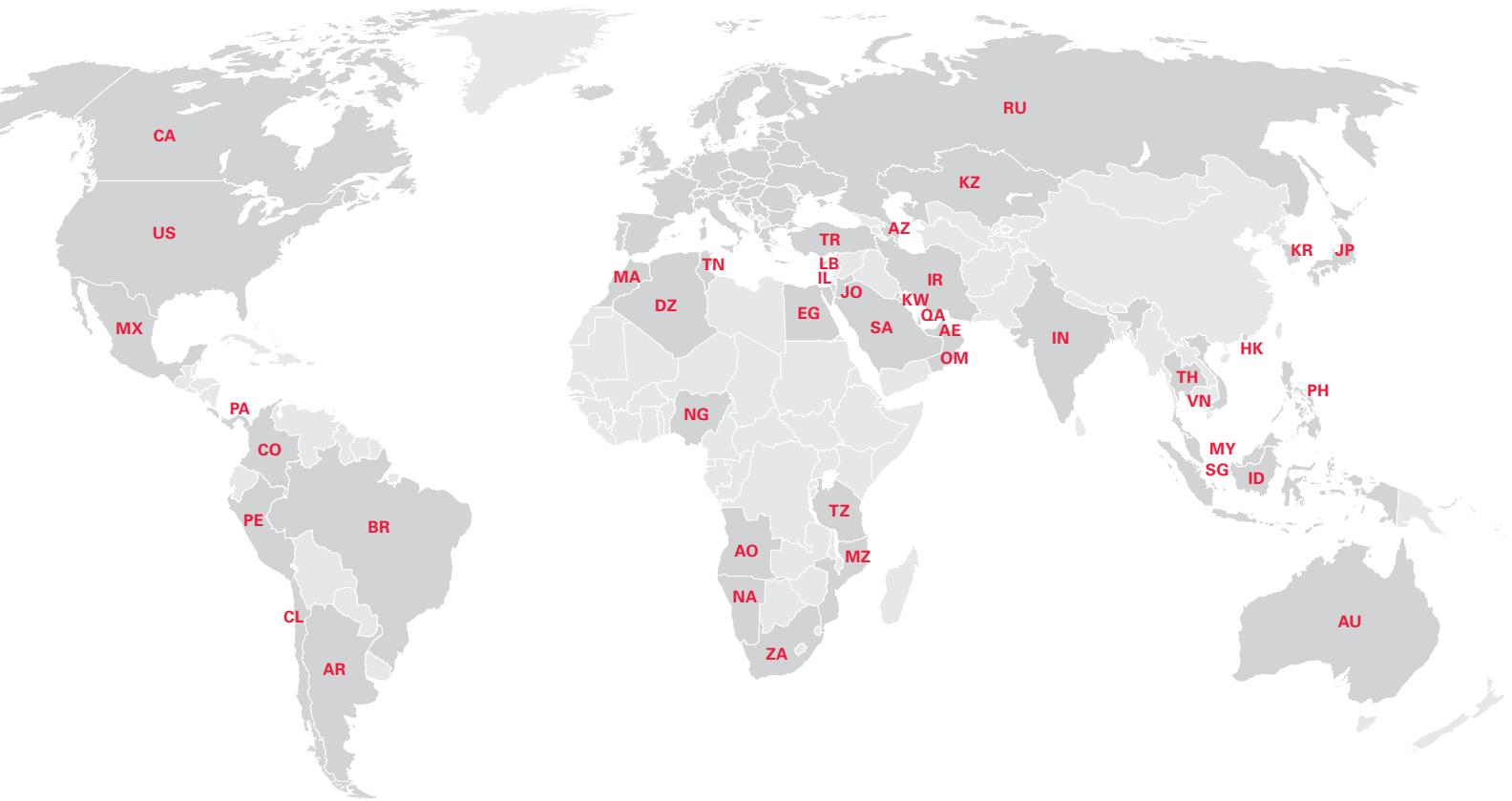

North America

- CA** Canada
PERI Formwork Systems, Inc.
www.peri.ca
- MX** Mexico
PERI Cimbras y Andamios, S.A. de C.V.
www.peri.com.mx
- PA** Panama
PERI Panama Inc.
www.peri.com.pa
- US** USA
PERI Formwork Systems, Inc.
www.peri-usa.com

South America

- AR** Argentina
PERI S.A.
www.peri.com.ar
- BR** Brazil
PERI Formas e Escoramentos Ltda.
www.peribrasil.com.br
- CL** Chile
PERI Chile Ltda.
www.peri.cl
- CO** Colombia
PERI S.A.S.
www.peri.com.co
- PE** Peru
PERI Peruana S.A.C.
www.peri.com.pe

Africa

- AO** Angola
Pericofragens, Lda.
www.peri.pt
- DZ** Algeria
S.A.R.L. PERI
www.peri.dz
- EG** Egypt
Egypt Branch Office
www.peri.com.eg
- MA** Morocco
PERI S.A.
www.peri.ma
- MZ** Mozambique
PERI (Pty.) Ltd.
www.peri.co.mz
- NA** Namibia
PERI (Pty.) Ltd.
www.peri.na
- NG** Nigeria
PERI Nigeria Ltd.
www.peri.ng
- TN** Tunisia
PERI S.A.U.
www.peri.es
- TZ** Tanzania
PERI Formwork and Scaffolding Ltd
www.peri.co.tz
- ZA** South Africa
PERI Formwork Scaffolding (Pty) Ltd
www.peri.co.za

Asia

- AE** United Arab Emirates
PERI (L.L.C.)
www.peri.ae
- AZ** Azerbaijan
PERI Representative Office
www.peri.com.tr
- HK** Hong Kong
PERI (Hong Kong) Limited
www.perihk.com
- ID** Indonesia
PT Beton Perkasa Wijaksana
www.betonperkasa.com
- IL** Israel
PERI F.E. Ltd.
www.peri.co.il
- IN** India
PERI (India) Pvt Ltd
www.peri.in
- IR** Iran
PERI Pars. Ltd.
www.peri.ir
- JO** Jordan
PERI GmbH – Jordan
www.peri.com
- JP** Japan
PERI Japan K.K.
www.peri.co.jp
- KR** Korea
PERI (Korea) Ltd.
www.perikorea.com
- KW** Kuwait
PERI Kuwait W.L.L.
www.peri.com.kw
- KZ** Kazakhstan
TOO PERI Kazakhstan
www.peri.kz
- LB** Lebanon
PERI Lebanon Sarl
lebanon@peri.de
- MY** Malaysia
PERI Formwork Malaysia Sdn. Bhd.
www.perimalaysia.com
- OM** Oman
PERI (L.L.C.)
www.peri.ae
- PH** Philippines
PERI-Asia Philippines, INC.
www.peri.com.ph
- QA** Qatar
PERI Qatar LLC
www.peri.qa
- SA** Saudi Arabia
PERI Saudi Arabia Ltd.
www.peri.com.sa
- SG** Singapore
PERI Asia Pte Ltd
www.periasia.com
- TH** Thailand
Peri (Thailand) Co., Ltd.
www.peri.co.th
- TR** Turkey
PERI Kalıp ve İskeleleri
www.peri.com.tr
- VN** Vietnam
PERI ASIA PTE LTD
www.peri.com.vn



PERI

**PERI GmbH
Formwork Scaffolding Engineering**

Rudolf-Diesel-Strasse 19
89264 Weissenhorn
Germany
Tel. +49 (0)7309.950-0
Fax +49 (0)7309.951-0
info@peri.com
www.peri.com

Oceania

AU Australia
PERI Australia Pty. Ltd.
www.periaus.com.au

DK Denmark
PERI Danmark A/S
www.peri.dk

IT Italy
PERI S.r.l.
www.peri.it

SE Sweden
PERI Sverige AB
www.peri.se

Europe

EE Estonia
PERI AS
www.peri.ee

LT Lithuania
PERI UAB
www.peri.lt

SI Slovenia
PERI oplate i skele d.o.o
www.peri.com.hr

AL Albania
PERI Kalıp ve İskeleleri
www.peri.com.tr

ES Spain
PERI S.A.U.
www.peri.es

LU Luxembourg
N.V. PERI S.A.
www.peri.lu

SK Slovakia
PERI spol. s. r.o.
www.peri.sk

AT Austria
PERI Ges.mBH
www.peri.at

FI Finland
PERI Suomi Ltd. Oy
www.perisuomi.fi

LV Latvia
PERI SIA
www.peri-latvija.lv

UA Ukraine
TOW PERI
www.peri.ua

BA Bosnia and Herzegovina
PERI oplate i skele d.o.o
www.peri.com.hr

FR France
PERI S.A.S.
www.peri.fr

NL Netherlands
PERI b.v.
www.peri.nl

BE Belgium
PERI N.V.
www.peri.be

GB United Kingdom
PERI Ltd.
www.peri.ltd.uk

NO Norway
PERI Norge AS
www.peri.no

BG Bulgaria
PERI Bulgaria EOOD
www.peri.bg

GR Greece
PERI Hellas Ltd.
www.perihellas.gr

PL Poland
PERI Polska Sp. z o.o.
www.peri.com.pl

BY Belorussia
IOOO PERI
www.peri.by

HR Croatia
PERI oplate i skele d.o.o.
www.peri.com.hr

PT Portugal
Pericofragens Lda.
www.peri.pt

CH Switzerland
PERI AG
www.peri.ch

HU Hungary
PERI Kft.
www.peri.hu

RO Romania
PERI România SRL
www.peri.ro

CZ Czech Republic
PERI spol. s r.o.
www.peri.cz

IR Ireland
Siteserv Access & Formwork
www.siteservaccess.ie

RS Serbia
PERI oplate d.o.o.
www.peri.rs

DE Germany
PERI GmbH
www.peri.de

IS Iceland
Armar ehf.
www.armor.is

RU Russia
OOO PERI
www.peri.ru

**The optimal System
for every Project and
every Requirement**



Wall Formwork



Column Formwork



Slab Formwork



Climbing Systems



Bridge Formwork



Tunnel Formwork



Shoring Systems



Construction Scaffold



Facade Scaffold



Industrial Scaffold



Access



Protection Scaffold



Safety Systems



**System-Independent
Accessories**



Services



PERI GmbH
Formwork Scaffolding Engineering
 Rudolf-Diesel-Strasse 19
 89264 Weissenhorn
 Germany
 Tel. +49 (0)7309.950-0
 Fax +49 (0)7309.951-0
 info@peri.com
 www.peri.com

